

# SEASIDE SCHOOLS

## CONSTRUCTION PROJECT



**SCHOOL BOND PASSES!**  
**Thank you!**



# SSD MEET & GREET - AGENDA

- **EVENT START 5 pm**
- **PRESENTATION STARTS 5.15 pm**
  - **Welcome Message – Sheila Roley**
  - **Bond Financials – Justine Hill**
  - **Project Overview & Schedule – DAY CPM**
  - **Project Approach & CM/GC Timeline– DAY CPM**
  - **Community Engagement – DAY CPM**
  - **Design Update – DOWA-IBI**
  - **Q&A**
  - **Networking**



# PROJECT OVERVIEW

## PROGRAM

BUILDING	GROSS SQFT
<b>ELEMENTARY SCHOOL</b>	
EXISTING	67,000
NEW	31,000
<b>MIDDLE SCHOOL</b>	
NEW	33,000
<b>MIDDLE &amp; HIGH SCHOOL SHARED</b>	
NEW	50,481
<b>HIGH SCHOOL</b>	
NEW	86,000

- Existing School District Property approximately 19 Acres
- Weyerhaeuser donated property approximately 80 Acres

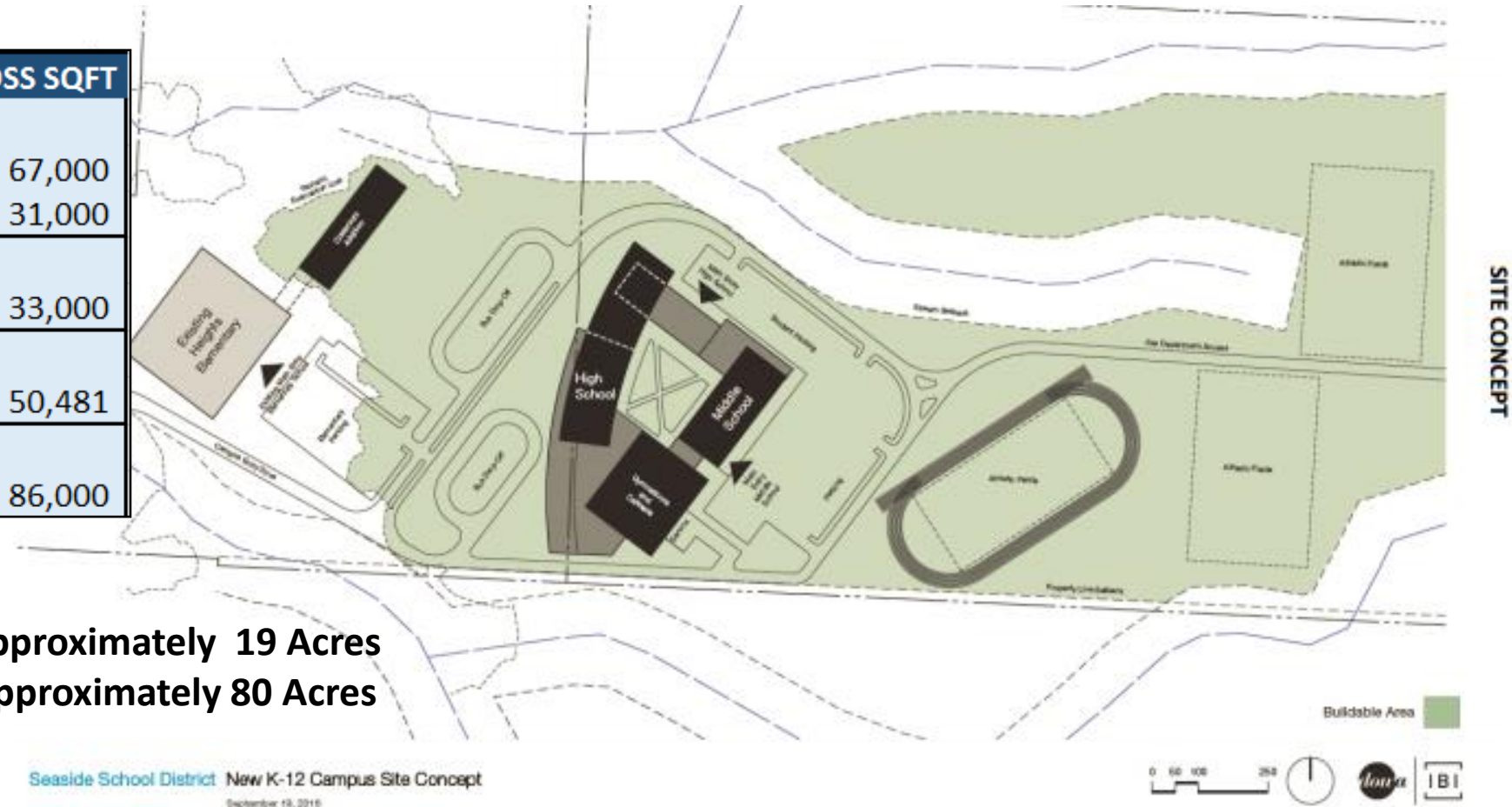

# SEASIDE SD 2016 – PROJECT TIMELINE

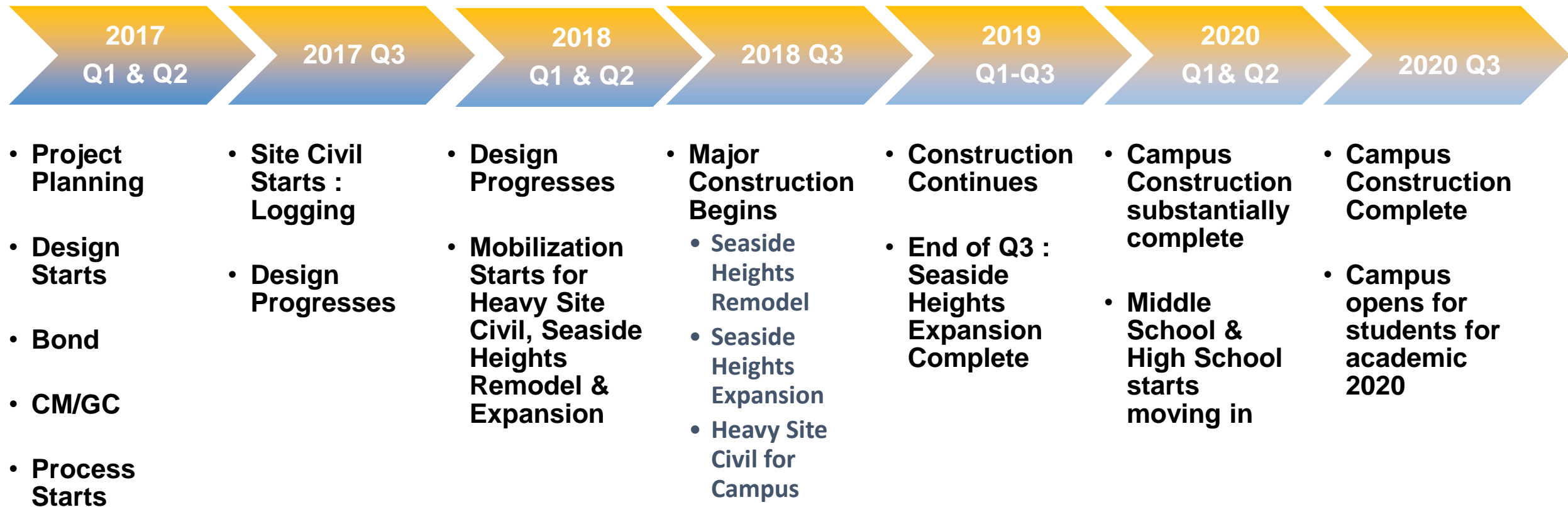

# GUIDING PRINCIPLES OF CM/GC COLLABORATIVE PROJECT DELIVERY

- Key participants bound together as equals Shared Risk & Reward
- Collaborative Decision Making
- Fiscal Transparency
- Eliminate Overlap in Services
- Fewer conflicts, RFIs, more pre-fabrication, less waste
- Early Involvement Key Participants
- Dynamic Cost Modeling



# CM/GC PROCESS TIMELINE

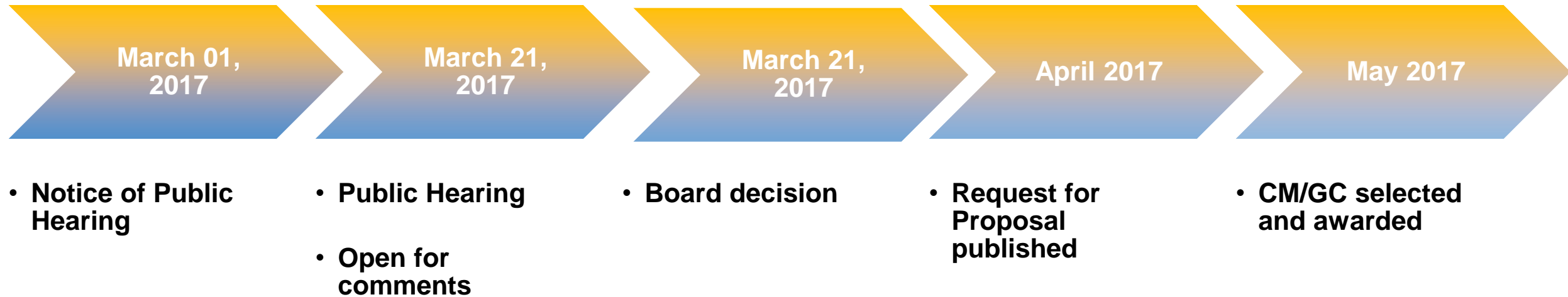

# PROJECT GOALS

- COMMUNITY PRIDE – A place for community
- FORWARD THINKING
- SUSTAINABLE – Rooted to place
- RESILIENT
- STEAM Partnerships





# LOCAL AND DIVERSE COMMUNITY ENGAGEMENT PROGRAM

- Program Impact Opportunity & Goals:
  - Local and Diverse Contracting
  - Workforce & Apprenticeship
  - Student Career Technical Education / STEAM
  - Social & Environmental
  - Mentoring & Mentor-Protégé
  - Partner Development
- Project website communications
- Open house meetings and Program reporting





# DESIGN UPDATE

## DESIGN PROCESS

Ed Specs / Visioning

Master Planning

Schematic Design

Design Development

Construction Documents

Construction

## DESIGN GUIDING PRINCIPLES

- Design student centered and community focused facilities
- Provide facilities that reflect the community, culture and natural environment
- Facilities (new and old) should be timeless, cohesive, flexible and inspirational
- Construct facilities that create spaces for instruction, performance, athletics and community
- Incorporate natural light to enhance learning environment
- Design facilities and spaces that are inclusive and age appropriate at all grade levels
- Good stewards of the community and their investments

RESPONSIVE ● RELIABLE ● RESPONSIBLE

# Q&A