



Creekside

## **School Information & Plans for Opening of 20-21 School Year**

**All plans below may change during the school year based on current conditions**

### **Calendar of Events**

Aug 4th - Open House - All Virtual

Aug 7th - 1st Day of School

### **Open House**

- Virtual for PreK-5

### **School Times**

- 7:05 - Buses unload and student drop off begins
- 7:35 - Tardy bell rings and instruction begins
- 2:40 - End of the school day

### **Masks**

- Students will have to wear masks
- Teachers and staff will have to wear masks

### **1st Day of School for 1st - 5th students - AUG 7**

- No walk-in drop off for 1st - 5th
- All 1st - 5th students must use the north or south car line or bus
- Students will go straight to their classroom
- Kindergarten will have a separate plan (see below)

### **1st Days of School for Kindergarten - AUG 7-13**

- Aug 7 & 10 - Girls only
  - 745 - K
  - 800 - K
  - 815 - K
- Aug 11 & 12 - Boys only
  - 745 - K
  - 800 - K
  - 815 - K
- K parents walk in to drop off with a mask on between 7:45-8:15 on these days
  - Parents should park in the south parking lot (by the soccer fields) and enter the 2 doors on the south side of the Primary building
  - Parents not wearing masks will have to stop at the door



## Creekside

- Aug 13 - All K students will be dropped in car line @ normal carline time (north or south)

### **Breakfast and Lunch**

- Breakfast will be picked up by students & will eat in the classroom
- Lunch will be picked up by students & will eat in the classroom
  - Students will not touch the keypad
  - Lunch staff will put in numbers
- The date for lunchroom use will be determined at a later time

### **Regular Classroom**

- Teachers will wear masks
- Students will wear masks
  - LCS will provide masks for students who do not have one
- We will practice “social distancing” in the classroom to the best of our ability
- Students will be washing their hands and sanitizing their work stations on a routine basis
- All staff will model appropriate social distancing and explain social distancing to students daily.
- Techniques such as placing an X on the floor to give a visual distance will be used

### **PE Classes**

- Classes will line up and practice “social distancing” as they move from the classroom to the gym
- Social distancing during PE will be monitored by the teacher
- We will use the playground space and be outside as much as possible
- Playground areas and equipment will need to be cleaned in the afternoons and in between classes if needed
- On rainy days we will be in the gym and practice social distancing

### **Monitoring the health of students**

- Parents are strongly encouraged to monitor their child before sending to school and keep their child home if they show any signs of being sick
- We will not be taking student temperatures on a daily basis
- As students show symptoms we will take temperatures and contact parents as needed
- Our nurse’s station will now include a “sick room” and a “well room”
- The nurse will clean and disinfect both rooms throughout the day
- Students with a fever will be sent home and cannot return to school until 24 hours fever free (per student handbook)
- Parents should contact the school nurse immediately if their child tests positive for COVID
- 
-



Creekside

- COVID Information - If...Then statements

<b>IF</b>	<b>Then</b>
An <b>elementary</b> student receives a positive COVID-19 diagnosis (exposure outside of school)	Report this to school administration and isolate for 10 days from the positive test date and must be fever free for 24 hours and symptoms have improved. Must provide a medical excuse before returning to school.
An <b>elementary</b> student is exposed to COVID-19 outside of school (has not exposed classmates)	The student is asked to self-quarantine for 14 calendar days from the date of exposure and will not be allowed in school during that time. Students will work remotely using a district-issued device with make-up work from the classroom teacher through Google Classroom.
An <b>elementary</b> student exposes the class to COVID-19	Admins must notify all parents and have the students in that class stay home for 14 calendar days and recommend quarantine and monitoring for s/s of COVID-19. They need to obtain more guidance from the ADPH.
An <b>elementary</b> teacher is exposed to COVID-19 outside of school (i.e. has a family member with a positive diagnosis, etc.)	Teacher has had a Direct Contact, so he/she needs to stay home for 14 calendar days after last contact with a person testing positive for COVID-19. Will need to self-monitor. (Her class has had indirect contact and can continue to come to school). Side note-This would be a good time to do temperature checks on the whole classroom.
An <b>elementary</b> teacher tests positive for COVID-19 but hasn't been around students	Report this to school administration and isolate for 10 days from the positive test date and must be fever free for 24 hours and symptoms have improved. The teacher should obtain further guidance from the ADPH.
An <b>elementary</b> teacher tests positive and has been around students	See above, plus, all staff/students in Direct Contact with that teacher will be sent home and asked to quarantine and monitor symptoms for 14 calendar days. Inform them that the ADPH should call them with further guidance. Recommend they call their PCP.



## Creekside

### **Cleaning and Sanitizing**

- Creekside staff will be cleaning and sanitizing classrooms and other areas of our school more often and will be using the latest technology in sanitizing.

### **Field Trips**

- No Field Trips until further notice
- Will re-evaluate after Labor Day and then after the first 9 weeks

### **Extended Day**

- At this time we have decided to cancel Extended Day services for the 1st semester
- If we are able to open up Extended Day services we will notify parents

### **Yearbooks from 19-20**

- Yearbooks have arrived
- We will distribute yearbooks at the start of the 20-21 school year to those that ordered
- Once all yearbooks have been distributed we will sell any extras

### **Buses**

- Buses will be provided
- Students will be social distanced on the bus and given an assigned seat
- Buses will be sanitized after morning and afternoon routes

### **Visitors**

- At this time we will not be allowing visitors for lunch or classroom visits

### **Check-ins and Check-outs**

- Parents must wear a mask before entering the school building

### **Afternoon Dismissal**

- Creekside Primary and Elementary have separate dismissal areas
- CPS will dismiss from the CPS gym and lunchroom
- CES dismisses from the CES gym

### **\*\*\*Arrival & dismissal procedures for Creekside Primary and Creekside Elementary:**

\*\* See map on last page \*\*

### **Morning procedures:**



## Creekside

Buses will drop off behind the new gym starting @ 7:05.

### **North car line** drop off starting @ 7:05.

- Cars enter the north entrance on Sanderson Road and follow a double line to the drop off location by the awning. (see map)
- All north car line students enter through the doors by the lunchroom and will walk to class.
  - 6 - North entrance
- Exiting
  - Left lane will exit and turn left on Sanderson Rd
  - Right lane will exit and turn right on Sanderson Rd

### **South car line** drop off starting @ 7:20.

- No matter what grade your child is in they can enter any door (North, Front or South side) and then walk to class.
- 5 entrances (see map)
  - 1 - CP front
  - 2 - South A
  - 3 - South B
  - 4 - South C
  - 5 - CE front
- We will have staff and “Creekside Chiefs”, 5th student helpers, located at each entrance to walk students to class if needed.
- It may be easier for your K student or new student to be dropped off in the same place each door if you use North Carline. They can use this door to drop

**Breakfast** is free and students will eat in the classroom

**Tardy bell** rings @ 7:35.

**Afternoon procedures:**

**Buses** will load behind the new gym starting @ 2:40.

Car line for **K-2 students** will be on the **North** side.

Car line for **3-5 students** will be on the **South** side

**Notes:**



## Creekside

- If parents have children in both schools, then parents will have the **choice of North or South** car lines. Please inform both teachers with notes and your children so we can direct them to the proper car line. The same is true if you are carpooling. Please do not change this once you set your desired pick-up location.

### **Creekside Primary Dismissal - K-2 students**

- K-2 Parents will enter the North entrance and follow the car line into our pick up area. We load in double lanes on the North side. The left lane must turn left and the right lane must turn right on Sanderson Rd.
- K-2 students will go into the Primary gym and the Lunchroom and wait to load on the North side. Students will listen for their number to be called and will go out in groups.

### **Creekside Elementary - 3-5 students**

- 3-5 Parents will enter the South entrance and follow the car line into our pick up area in front of CES.
- 3-5 students will go into the new gym to wait for their number to be called and then go out in groups.

### Other notes:

- Our resource buses and daycare vans will use the CPS Front pickup lane. Do not block this lane.
- Remember to stay in your car, stay off your phones and pay attention during car line time. All of these things help our car line run safely.

\*\* SEE MAP ON THE NEXT PAGE ----->>





Creekside

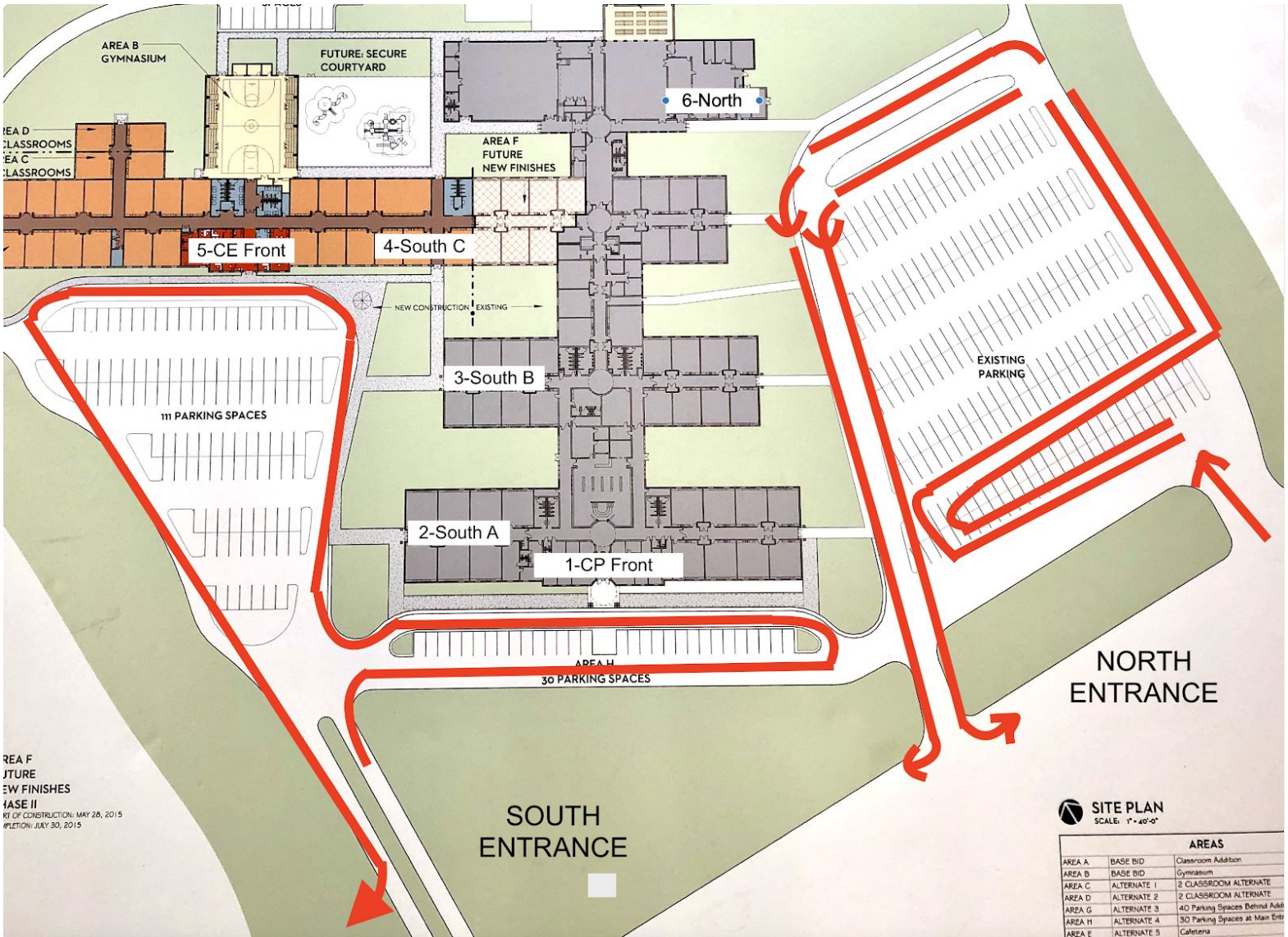

AREA F  
FUTURE  
NEW FINISHES  
PHASE II  
START OF CONSTRUCTION: MAY 28, 2015  
COMPLETION: JULY 30, 2015

**SITE PLAN**  
SCALE: 1" = 40'-0"

AREAS		
AREA A	BASE BID	Classroom Addition
AREA B	BASE BID	Gymnasium
AREA C	ALTERNATE 1	2 CLASSROOM ALTERNATE
AREA D	ALTERNATE 2	2 CLASSROOM ALTERNATE
AREA G	ALTERNATE 3	40 Parking Spaces Behind Addition
AREA H	ALTERNATE 4	30 Parking Spaces at Main Entrance
AREA E	ALTERNATE 5	Cafeteria