

North Middle School

2990 Decherd Boulevard

Winchester, TN 37398

931-967-5323

www.northmiddle.fcstn.net

www.facebook.com/nmsfranklincountyttn



2021-2022

Student and Parent Handbook

North Middle Parents/Guardians and students,

The faculty and staff of North Middle are excited to partner with students and parents/guardians for the 2021-2022 school year. We strive to accomplish our mission of providing a caring, progressive, educational environment where students have the opportunity to develop to their highest potential and become prepared for the next level of education through mastery of academic, social, cultural, and physical endeavors. This goal cannot be met without your support. The purpose of this handbook is to establish the link between home and school and to be transparent with the expectations, policies, and procedures that will be used to navigate the school year. We encourage communicating any concerns or questions and appreciate working together to create the best learning environment for our students.

Respectfully,

Holly Eslick, Principal

Ric Roberts, Assistant Principal

HELP YOUR CHILD BECOME SUCCESSFUL IN MIDDLE SCHOOL

A successful middle school experience starts in the home because the parent is the first teacher of the student. It is your privilege and obligation to teach by example and to develop your student's good habits of behavior as well as a positive attitude toward school. To help your child's progress in middle school, we suggest to:

- Monitor your child's attendance and academic progress. (Online Parent Access to Skyward is available. Contact the school office for a password and instructions.)
- Read the Student/Parent Handbook with your student to familiarize yourself with the procedures used at NMS.
- Recognize that the teachers take the place of the parent while your child is at school.
- Teach and require your child to have respect for the law, for authority, for the rights of others, and for private and public property.
- Become an active part of the school by attending school activities, checking on your child regularly with his/her teachers, counselor, or an administrator, and by serving on various school committees.
- Talk with your child about school activities and show an active interest in report cards and the daily progress of your child. Ask your child daily what was learned.
- Encourage and demand prompt and regular school attendance and comply with attendance rules and procedures.
- Safeguard the physical and mental health of your child and be responsible for periodic health examinations.
- Attend individual or group parent conferences. Request conferences as you see a need.
- Arrange for a time and a place at home for homework assignments, supervise your child, and check the work.
- Monitor and sign your child's Student Planner on a regular basis.
- Work with North Middle School in carrying out recommendations made in the best interest of your child.
- Know your child's friends and monitor social media accounts. Encourage and guide wholesome friendships, interests, and activities.
- Understand and comply with the rules of the school concerning student conduct and cooperate with the school in carrying out disciplinary action.
- Contact the school with your concerns or compliments.

Agendas/Handbook

In order to help students develop organizational skills, encourage parent-teacher communication, and help students keep track of teachers' assignments, attendance, and other important documentation, the school has issued, free of charge, this agenda. The agenda is required and must be kept in each student's possession throughout the school day. The replacement cost is \$10.00

Arrival

North Middle School will open at 7:00 a.m. No students should be left unattended outside of the school prior to that time. All students will report directly to the gymnasium or to the cafeteria to eat breakfast.

Students who are dropped off by parents or guardians will enter campus from Highway 41-A and enter the building through the main front entrance. Students who are dropped off by buses will enter the building through the exterior doors between the gymnasium and cafeteria.

Students entering the building after 8:00 a.m. are required to be signed in through the front office.

Assemblies/Pep Rallies

North Middle School is fortunate to have facilities for plays, programs, and special events. Visitors often form a lasting impression of our school by our behavior at assemblies; therefore, students are expected to enter programs quietly and with their best manners. This includes keeping their hands and feet away from others, sitting quietly during performances, and showing their appreciation by clapping and cheering at appropriate times.

Athletic Programs

North Middle School offers a variety of athletics for students which are governed by the TSSAA rules and regulations.

School Requirements

North Middle School student athletes and parents will:

1. recognize that participating in school athletics is a privilege not a right.
2. follow all coaches' policies, procedures, rules and expectations.
3. abide by TSSAA regulations (www.tssaa.org).
4. follow and adhere to North Middle Schools' and Franklin County Schools' Code of Behavior and Conduct.
5. recognize and follow Chain-of-Command if an athletic issue arises. First, the athlete meets and speaks with the coach individually. Second, the parent/guardian and athlete speak with his/her coach. Third, (and only if resolution is not met) athlete, parent, and coach meet with the Athletic Director. Fourth, (and only if no other resolutions have not been met) athlete, parent, coach, Athletic Director meet with Principal.

North Middle School student athletes will:

6. have outstanding attendance at school.
7. attend school on days of games and practices for a minimum of three and one half hours.
8. earn passing grades (no F's) on progress reports and report cards.

9. ride a school bus (when provided) to and from all athletic events. Parents may sign out their own child/ren to ride home. No student/s shall be signed out by another parent to ride home with someone else.

Athletics/Seasons offered at North Middle School

Fall	Winter	Spring
Football Girls Soccer Cross Country Cheerleading Volleyball	Girls Basketball Boys Basketball Cheerleading	Softball Baseball Track and Field Boys Soccer

Attendance (Board Policy 6.200)

Every parent/guardian/legal custodian or other persons residing within the State of Tennessee having control or charge of a child and/or children between six (6) and seventeen (17) years of age, both inclusive, shall cause such child or children to attend public or private day school and, in the event of failure to do so, shall be subject to penalties hereinafter provided.

Students are learning through their experiences traits that will carry over into their adult life. Therefore, being on time and attending school regularly are important factors for establishing responsibility. It is important that all students Pre K-12 attend full days of school.

The state of Tennessee has many laws which deal with education and school attendance. The law states that every parent/guardian having control or charge of a child/ren between six and seventeen years of age shall cause such child/ren to attend public or private day school and, in the event of failure to do so, shall be subject to penalties. Tennessee Code Annotated 49-6-3007 states that the parents/guardians of K-12 children, who are absent more than five days during any school year without adequate excuse, may be fined up to \$50.00 or assessed five hours of community service at the discretion of the judge.

Tennessee Code Annotated 49-6-3009 states that any parent/guardian who has control of any school age child/ren and who shall violate the provisions of attendance shall be guilty of a Class C misdemeanor. Each day/s unlawful absence shall constitute a separate misdemeanor. A Class C misdemeanor is punishable by a \$50.00 fine and/or ten days in jail for each offense.

If your child/ren is/are absent from school, a written excuse from parent/guardian or doctor must be submitted to the attendance office. Failure to do so, after three days, will result in the absence being marked “unexcused.” North Middle School will accept five (5) parent/guardian notes as excused absences. Absences beyond five (5) days will require a doctor’s note to be considered excused. Consecutive absences of three (3) days or more require a doctor’s excuse. All doctor’s notes may be verified by the school’s Attendance Office and/or Parent/Student Attendance Mentor.

The note must contain all of the following:

1. Student’s full name
2. Date of the absence(s)
3. Reason for the absence(s)

4. Telephone number where the parent/guardian can be reached
5. Parent/guardian signature

Absences and tardiness for grades Pre K-12 shall be classified as either excused or unexcused as determined by board policy and the principal.

Excused absences and tardiness

- A. Personal illness
- B. Illness of immediate family member, to include mother, father, brother, sister
- C. Death in family
- D. Extreme weather conditions
- E. Religious observations
- F. Circumstances, which in the judgment of the principal create emergencies, over which the student has no control

Unexcused absences—Any absences not excused will be unexcused.

When a student accumulates **five (5) unexcused absences**, the parent(s)/guardian(s)/legal custodian(s) shall be notified in writing. A new notice shall be sent after each successive accumulation of five (5) unexcused absences. Should a student accumulate ten (10) unexcused absences, the parent(s)/guardian(s)/legal custodian(s) and the student shall be petitioned to the Franklin County Juvenile Court for violating the provisions of attendance.

Backpacks

Any form of a bag is not allowed in classrooms during school hours. All bags must be kept in the student's locker. Backpacks, including contents, are the responsibility of students to keep up with and retrieve from lost and found if needed. The school is not responsible for lost, misplaced, or stolen items or backpacks.

Bookstore School

Supplies are available for students to purchase each morning between 7:45 a.m.- 8:00 a.m. in the attendance office.

Bus Conduct (Board Policy 6.308)

In order to maintain conditions and atmosphere suitable for learning, no person shall enter onto a school bus except students assigned to that bus or parents of students or other persons with lawful and valid business on the bus. The school bus is an extension of school activity; therefore, students shall conduct themselves on the bus in a manner consistent with the established standards for safety and classroom behavior. Please contact the bus driver with questions or concerns. The director of transportation should be contacted in the event that the bus driver does not address questions or concerns at 931-967-0626.

To locate what bus your student should ride, please use the district [Bus Locator](#).

Cafeteria

Breakfast/Lunch

Breakfast and lunch is served each day in the cafeteria. North Middle School students may bring lunch from home or get lunch from the cafeteria. Students who have food allergies are required to submit a Diet Prescription Form from his/her doctor. State and Federal guidelines prohibit fast food meals being brought into the cafeteria during school lunch hours.

Meals will be at no cost to students for the 21-22 school year. Lunch applications will still be sent and we encourage parents who feel they will qualify for free or reduced meals to fill the application out. This is beneficial for P-EBT benefits and will be used as a temporary status for the following school year when we return to "normal" pricing.

Charges

Students in grades 6–12 may NOT charge for extra items. The School Messenger System will notify parents of the amount of charges owed. Once notification has been issued, it is expected that parent/guardian will make every effort to pay lunch charges in a timely manner. Furthermore, your child's report card, diplomas, field trips, and/or special events may be withheld until all fees owed to the school are paid in full. The school principal shall take all necessary legal efforts (including garnishments) to collect all monies (plus the accompanying accrued expenses) owed by the child. Parents may monitor and deposit monies into individual student accounts through www.mynutrikids.com to purchase extra items (ice cream, etc.).

Cellular Phones and Other Personal Communication Devices (Board Policy 6.312)

Students' use of cellular phones and other communication devices upon entering the school building before 8:00 am is at the principal's discretion. After 8:00 am and until 3:00 pm (or when school is officially dismissed), the use of these devices (excluding school issued Chromebooks) is prohibited unless the school principal has approved a written request:

- From a teacher for his/her students to use their own devices to enhance learning when the school issued Chromebooks are not sufficient; or
- Student to self-monitor specific health issues/concerns (must include verification from the medical provider).

For the purpose of this policy, use of such a device means either receiving or sending a message by the emission of an audible signal or sound, vibration, or visual display. The device is deemed to be 'in use', even if the device is not answered. Possession of a cellular phone or other communication device is not a violation of this policy (except for elementary school students who are not permitted to have a cell phone at school) if the phone or device is in a purse, pocket, book bag, locker, or automobile and is not in use during the regular school day. School employees who discover a student using a phone or other personal communication device in violation of this policy shall confiscate the device and submit it to the principal or designee.

Violation of this policy will result in the student's cell phone being confiscated as follows:

1st offense – held for the remainder of the day, to be returned to the student;

2nd offense – held for the remainder of the day, to be returned to the parent/guardian; and

3rd offense – the student is not allowed to have a cell phone for the remainder of the school year.

For subsequent violations or if a student fails to relinquish his/her cell phone to the teacher or principal, the student will be sent to the Alternative School for twenty (20) days; qualifying students, with an IEP, must continue to be served in accordance with the applicable state and federal laws. Students who use the camera component of the cell phone in an unauthorized manner are subject to additional disciplinary measures, as well as reported to the appropriate law enforcement agency, if deemed appropriate. In case of internet outage – students' use of personal communication devices for instructional purposes shall be at the discretion of the classroom teacher. This policy shall be included in the Code of Conduct which is on the system's web-site.

Changes in Student Information

During the course of the school year, the school may need to contact the parent. It is the parents' responsibility to inform the office of any changes in student information. This would include: change of address, change of phone number/s, change of guardianship, or additions to emergency contacts.

Checking Out

When it is necessary for a student to leave school during any part of the school day, he/she must be signed out in the front office. Only parents/guardians may sign out students, unless the school receives notification. The authorized person must sign the student out and complete a sign out slip with the dismissal time and reason. Because the end of the school day is a very busy time, parents will be unable to check students out after 2:30 p.m. Therefore, if you plan to check your child out; this must be done prior to 2:30 p.m.

Computer/Chromebook and Internet Use

The use of computers/Chromebooks and access to the internet at North Middle is encouraged to enhance specific instructional objectives. The use of the internet must be in support of education and research and consistent with the educational objectives. Every student will be issued a Chromebook for his or her individual use and must adhere to the Franklin County Schools Chromebook Initiative and agreement that is signed and turned in before the Chromebook is issued annually. A monitoring and tracking system is in place on every school computer that maintains a cumulative history of accessed Internet sites as well as the user. Students may be banned from the use of school computers/Chromebooks and connective internet services if inappropriate and/or unlawful sites are found to have been accessed. Because of security issues and the risk of infecting the system network, students are not authorized to access personal email accounts at school.

Clubs and Organizations (Board Policy 6.702)

Student organizations are an extension of the academic curriculum and are intended to complement the basic instructional program.

To become active members or participate in any activities of a club or organization, written communication from the student's parent or legal guardian must be signed and dated by the parent or legal guardian. One or more staff members will serve as faculty advisors of each activity and will attend all meetings to ensure all applicable Board policies, administrative procedures and school rules are followed. Each faculty advisor will evaluate the activity and make recommendations concerning changes, continuance, or deletion from the school's activity program.

Clubs/Organizations available to NMS students:

- **Beta Club**: This club is an honorary club with the mission to promote ideals of academic achievement, character, and leadership among high school students. Students are invited to participate as members of Beta Club based on grades during the Spring semester of their 6th or 7th grade years.
- **Fellowship of Christian Athletes**: FCA is a religious club that is a nondenominational organization with the mission to fellowship together sharing student love of Jesus Christ. This organization is not limited to athletes.
- **Tech Club**: This organization meets weekly to work on STREAM/technology projects.

Code of Behavior and Discipline (Board Policy 6.300)

The Code of Behavior and Discipline is to notify students, parents/guardians/legal custodians, school system employees, and others of the standards of expected student behavior, and the consequences of the failure to obey such standards. This code is revised annually to comply with both federal and state laws as well as Franklin County School Board Policies, and to help provide and maintain a safe and secure learning environment, free of drugs, drug paraphernalia, dangerous weapons, and threats of physical or psychological harm.

The Franklin County Board of Education has developed these policies to comply with both federal and state laws to provide and maintain safe and secure schools. This document will be located on our school district's website at www.fcstn.net and our school website at www.northmiddle.fcstn.net.

Conferences

Communication is an essential key to your child's success at North Middle School; therefore, parent/teacher conferences are strongly encouraged. There will be pre-scheduled conferences during the 2021-2022 school year. These dates/times are: **Monday, October 18th, 2021 (3:15-6:15) and Monday, March 7th, 2022 (3:15-6:15)**.

Conferences can also be scheduled on an as needed basis. Prior to scheduling a conference, parents and teachers should attempt to communicate via email and phone calls. If solutions are not achieved, then an in-person conference with administration present is recommended.

COVID-19 Protocols

If any student has been exposed to a close contact or household member that has a confirmed positive COVID result or if the student him or herself has received a positive COVID result, North Middle School should be informed immediately and the student must quarantine per recommendations by a health care provider. The student can take his or her assigned chromebook home to work remotely during the time of quarantine and will need to communicate with teachers for instruction and assignments.

Parents/guardians will be notified if their student has been identified as a close contact or possible close contact if a peer or faculty or staff member receives a positive COVID result and was at school 48-hours prior to the result.

Detention (Before or After School Detention)

Students may be detained before or after the school day as a means of disciplinary action. Detention will be assigned from 7:00-7:45 in the mornings or 3:00-3:45 in the afternoons. The following

guidelines shall be followed: 1. The student will be given at least one day of notice before detention; 2. Parents will be informed before detention takes place.

Discipline Policy and Procedures

It is the duty of North Middle School to provide a safe, secure, and respectful environment that is conducive to learning for all students.

The Franklin County Schools Code of Conduct will be used as a guide to discipline problematic behavior. Appropriate behavior is essential for the success of any educational program. Maintaining order and discipline is a collaborative effort among the administration, faculty/staff, students, and parents of North Middle School.

At all times, students are expected to be:

- Respectful- Use appropriate language, follow directions, keep your hands and feet to yourself, treat others the way you want to be treated.
- Engaged- Participate in all classroom activities.
- Prepared- Come to school with all materials needed for class.
- Responsible- Be on time, do your work, clean up after yourself, dress appropriately, and maintain healthy relationships with your peers, parents, and teachers.
- Courageous- Learning something new takes courage. Do not be afraid to ask questions, help others when they need assistance, and be a leader.

General Disciplinary Infractions

General disciplinary infractions are divided into four categories of behavior:

- Behaviors that will physically hurt someone, including self, such as fighting, pushing, shoving, running in the hallway, throwing objects, carrying dangerous objects, and inappropriately using materials or equipment.
- Behaviors that hurt another person's feelings including: name calling, put-downs, intimidation, group isolation, sexual harassment, and other behaviors that are designed to devalue or hurt another person.
- Behaviors that damage, destroy, or cause the loss of personal or school property including the following examples: the irresponsible use of instructional materials, theft, malicious destruction or defacement, and manipulating locks or lockers other than your own.
- Behaviors that interrupt the instructional program, including: failure to bring the necessary materials for class such as books, paper, pen/pencils, and the P.E. Uniform; bullying, clowning, excessive attention-seeking and off-task behaviors, flagrant tardiness, speech that contains profanity or obscenities, play fighting, or inciting a fight.

***At all times, cooperative and appropriate behavior is expected in both classroom and non-classroom activities such as assemblies, athletic events, cafeteria, and other activities.

The following procedures are typically followed when inappropriate behavior is observed:

- Student's first behavioral problem in the classroom results in a teacher-student conference and/or written demerit.

- A second minor incident may result in a written demerit and/or teacher-student conference, followed by a second consequence such as a before school, lunch, or after-school detention. Teachers will notify parents whenever students are retained after school or if they may need to be at school earlier than normal. Teachers will document inappropriate behaviors in writing and when necessary notify the appropriate stakeholders. A conference with the School Counselor and/or Instructional Coach may be scheduled.
- Serious or repeated behavior problems will be referred to administration. Written documentation and a discipline referral form will accompany students who are sent to the office. The administrator will determine consequences, which could include lunch detention, before/after-school detention, Saturday school, in or out of school suspension, or a referral to the Alternative School program. The administrator will notify parents by telephone. The teacher will be notified of the action taken in writing via the original office referral.

*Parent/guardian contact is always expected and encouraged when dealing with student issues.

Discipline Authority

All members of the faculty and staff are responsible and expected to maintain order and discipline within their designated classrooms, school hallways, cafeteria, and during any other school related activity. The faculty and staff of North Middle School reserve the right to punish any student for misbehavior in order to maintain a conducive learning environment. It is expected that the faculty and staff will follow board policy and administrative procedures when administering student discipline. All disciplinary actions will be documented appropriately and handled professionally.

Demerits

Demerits should be given for minor offenses as a pre-referral intervention strategy. **Any** member of the faculty and staff at North Middle School may issue a demerit to any student at any given time for disciplinary infractions. Demerit forms will be turned in to the office (Jolley) for official documentation and the maintenance of disciplinary records. **The accumulation of 5 demerits in one grading period will result in an office referral and further disciplinary action.**

**Demerits serve as written documentation, not a singular consequence. It is expected that the faculty/staff member will use their professional discretion when applying any pre-referral intervention strategy and necessary punishment toward the offending party for minor offenses.

Appropriate consequences for demerits include, but are not limited to: parent contact, before/after school detention, hall isolation, lunch detention, classroom cleaning duty, assigned seat, and loss of privilege.

Misbehaviors and possible consequences

The following is not a complete list of possible infractions, but should serve as a guide for the students, faculty/staff, parents, and administration of North Middle School. The administration at North Middle School reserves the right to administer any discipline deemed necessary in accordance with school board policy.

Infraction	Description	Minimum	Maximum
Academic Dishonesty	Taking and using another's findings, interpretations, or texts and presenting them as one's own without proper attribution, using another's work or answers, unauthorized use of notes or study guides during testing.	zero for task, parent contact	Out of school suspension
Bullying (major)	Unwelcome statements or threats that are verbal, written, or physical that create a hostile environment, including harmful gossip and rumors.	Administrative referral, Parent notification	Out of school suspension
Bus Misbehavior	Inappropriate behavior at the bus stop, during transportation, or unloading the bus (This includes during bus duty).	Administrative referral, Parent notification	Bus suspension.
Cell phones/ electronic devices, and other inappropriate items Board Policy 6.312 (Major)	Possession and/or use during the instructional day of devices including,, but not limited to cell phones, iPods, electronic games, toys.	Confiscation of device, parent notification, Office referral	Failure to relinquish cell phone to administration will result in 20 day at the Alternative school
Computer Abuse	Inappropriate use of computer; violation of Chromebook agreement.	Staff intervention, loss of computer use, parent notification	Admin. Intervention
Disrespect (major)	Lack of respect or courtesy towards faculty, staff, or any other person throughout the school day or during any school activity	Staff intervention, parent contact	Saturday School/ OSS
Disruptive Behavior	Any behavior that interferes with the education or safety of others, or distracts or disrupts the learning environment.	Staff intervention, parent notification	Out of school suspension
Dress Code Board Policy 6.310 (major)	Any style of dress that is not in accordance with the dress code set forth by the Franklin County School Board.	Staff Intervention, parent notification, alternative clothing, behavior referral	Three (3) Dress Code violations will result in 20 days in Alt. School.
Extortion	Any act or attempt to secure money,property,	Out of school	Referral to Alt.

(major)	or personal gain through threat or physical harm.	suspension	School
Failure to report to detention or teacher assigned discipline (major)	Failure to serve assigned detention or other disciplinary action.	In school suspension	Saturday School
False Fire Alarm (major)	Vandalism/activation of the fire alarm	Suspension, parent notification, Fire Marshall Notification	Referral to Alt. School, police notification
False Official Statement (major)	False accusation, written or spoken	Administrative referral, parent notification	Out of school suspension
Fighting (major)	The act of engaging in physical harm to another student.	Out of school suspension	Police notification, court petition
Forgery	Producing counterfeit documents, including but not limited to parents signature or any document for school.	Staff intervention, parent notification	ISS or Saturday School
Gambling	Betting, wagering, or gambling on any game, including, but not limited to cards	Parent notification, confiscation	ISS, OSS, or Saturday School
Harassment (major)	Persistent and unwelcome statements or threats that are verbal, written, or physical	Detention	Out of school suspension
Horseplay	Rough or boisterous activity, not limited to pushing, shoving, and other physical contact	Staff intervention	ISS or Saturday School
Insubordination (major)	Refusing to carry out a reasonable request of a staff member, or to give one's name when requested.	Staff Intervention	ISS or Saturday School
Intimidation , Physical Verbal Threats (major)	Provoking fear in others	ISS	Referral to Alternative School
Leaving School	Leaving School grounds with permission	Suspension	Referral to

(unauthorized) (major)			Alternative School
Locker Infractions	Sharing a locker, tampering with or entering any locker other than one's own assigned locker.	Staff intervention, Administrative referral	Saturday School
Over-the-counter drugs	Use of OTC drugs during school without supervision from the school nurse	Parent notification	Administrative Referral
Physical Attack (major)	Physical assault of a staff member or student with intent to do bodily harm on school grounds or in conjunction with any school-related activity	Out of school suspension	Referral to Alternative School, Petition to court
Profanity, obscenities	Using profane, obscene, or vulgar language, drawings, gestures, etc..	Staff intervention, detention, parent contact	Out of school suspension
Public Displays of Affection (PDA)	Kissing, holding hands, embracing, etc.	Staff/ Counselor intervention	ISS or Saturday School
Sexual Harassment (major)	Repeated and unwelcome sexual advances, request for sexual favors, and/or any other inappropriate verbal, written, or physical conduct of a sexual nature	ISS	Out of school suspension, Referral to alternative school, Police notification
Skipping Class	Failure to report to class or assigned area within a reasonable time	Staff intervention, Detention, parent contact	Saturday School
Tardiness	Arriving at school, class, or detention after the assigned time.	Staff intervention (Demerit) *3rd Offense: Office Referral	Saturday School
Theft/ Burglary (major)	Taking or being in possession of something that belongs to someone else	Out of school suspension, restitution	Referral to alternative school, restitution, referral to SRO
Tobacco/ e-cig (major)	The use or possession of any tobacco product or e-cig	Out of school suspension	Referral to SRO, court petition
Truancy	Illegal absences from school	Administrative	Referral to social

		action	worker, court petition
Vandalism/ Graffiti (major)	Destruction or defacement of school property; writing or drawing on anything that belongs to another.	Saturday school and restitution	Suspension, Referral to SRO, court petition
Verbal abuse (major)	Insulting or verbally abusing another; racial, ethnic, gender, and religious slurs are included in this policy.	ISS, parent contact	Out of School suspension

****Excessive infractions or failure to comply with administrative intervention may result in the following: immediate suspension, referral to the Alternative School, or intervention by the SRO.

Possible Consequences

<i>Minor Infractions</i>	<i>Major Infractions</i>
<ul style="list-style-type: none"> ● Time for Time ● Parent Contact ● Loss of Privilege ● Separation from Peers ● Behavior Project ● Detention (Before/After School, Lunch) ● Hall Isolation(Loss of Break) ● Restitution ● Extra Curricular Duties 	<ul style="list-style-type: none"> ● Restitution ● Structured Day ● In School Suspension (ISS) ● Self Containment ● Saturday School ● Out of School Suspension (OSS) ● Alternative School

Zero Tolerance/ Other

Violation	Description/ Policy	Minimum Placement
Alcohol	Possession and/or use of alcoholic beverages	1st offense: 45 days 2nd Offense: 60 days
Assault	Board policy 6.309	180 days
Drugs	Board Policy 6.309	180 days
Electronic Threats	Board Policy 6.309	180 days
Weapons & Dangerous Instruments	Board Policy 6.309	180 days

Disciplinary Records A disciplinary record shall be maintained by the classroom teacher and/or administrator and shall contain the name of the student, the type of misconduct, the type of punishment administered, the name of the school official administering the punishment, and the time

and date. This information will also be recorded in the Franklin County School System's student information system Skyward.

Dismissal

Your child's safety is our greatest concern at North Middle School. By supporting our efforts, you enable us to dismiss your child in an orderly manner without compromising your child's safety. To avoid confusion at the end of the day, daily dismissal plans for your child should be prearranged and communicated to the student. Any calls made to the NMS office to change your child's dismissal plan must be done prior to 2:30 p.m.

Students must be picked up by 3:30. After 3:30, parents/guardians must come into the front office to sign their student out.

Bus Riders

Students transported by an early bus will be dismissed at 2:55 p.m. from their classrooms. Early bus riders will report to the bus loading zones located between the cafeteria and gymnasium. Late bus students will report directly to the school's cafeteria at 3:00 p.m. Students riding late buses will be dismissed from the school cafeteria as buses arrive for pick up.

Car Riders

Students being picked up by car will be dismissed at 2:55 p.m. to the auditorium. For safety reasons, there is no waiting inside or standing outside the school building prior to dismissal of students. Because your child's safety is the first priority at North Middle School, all parents/guardians are expected to stay in vehicles during afternoon dismissal. Parking on the street and walking to pick up children is strongly discouraged. Parents are asked to pull up as far as possible to loading areas before stopping to let a child in the car. This will help traffic move more smoothly. By doing this, we are better able to dismiss your child in an orderly and timely manner without compromising your child's safety. To also encourage a prompt system, write the first and last name of your student on a standard sized piece of paper and display it in the front window of the car so that the person calling for students doesn't have to stop and ask.

Walkers

Students who walk home from school will be dismissed at 3:00 p.m. from the front of the school after early buses have left the campus. Written documentation signed by parent/guardian must be provided to the school prior to allowing students to walk.

Dress Code-Middle and High School Dress Code (Board Policy 6.310)

The Franklin County School System is committed to help create and maintain the very best learning environment possible. A correlation certainly exists between appropriate attire and a positive learning environment.

Any dress or hairstyle that is considered contrary to good hygiene, distractive or disruptive in appearance, detrimental to the educational environment or to the public image of the school shall not be allowed. **The administration of the school reserves the right and responsibility to determine whether a student's attire is within the limits of appropriateness for school, decency, and modesty. In matters of opinion, the judgment of the principal/designee shall prevail.**

A uniform dress code is in effect at the middle schools and high schools. The uniform dress code will include solid khaki (khaki-colored) pants, skirts, shorts, skorts or capris or appropriately solid-colored jeans, denim skirts, shorts, skorts or capris with no holes. Pants will be belted at the waist when appropriate. Shirts will be collared, or crew necked, with sleeves. Shirts may be solid-colored or patterned. The only logos that may be on a shirt will be – logos no larger than a six (6) by six (6) inch square. Shirts must completely cover the abdomen, back, shoulders, midriffs, and cleavage. Shirts will be tucked in the pants or skirts or, at the discretion of the school, allowed to be worn on the outside if worn neatly. Spirit wear depicting the school of attendance will be considered appropriate attire.

The following specific expectations have been established to help create and maintain the best learning environment:

1. All clothing must be clean, appropriate for school, and size appropriate. Clothing must not have holes, be cut-off, ripped, or see-through. The only logos allowed must meet the six (6) by six (6) inch square requirement on shirts. Spirit wear is allowed at any time and is identified as any clothing item that displays the student's assigned school's logo or publicizes a class, club or team that is recognized by the assigned school.
2. Shorts, skorts and capris must cover to the top of the knee when standing.
3. If leggings, jeggings, or tights are worn, the student's top or outer garment must cover to the top of the knee when standing.
4. Skirts shall be knee length when the girl is standing erect. Slits in dresses or skirts shall not exceed three inches above the front and/or back of the knee.
5. Pants must be worn above the hip-bone; sagging/bagging is not allowed. At this time, low rider and hip hugger style pants are permissible.
6. All coats, jackets, sweaters, and any other kind of outerwear may be solid-colored or patterned. Outerwear that is spirit wear depicting the school of attendance may be worn.
7. Footwear is required and must be worn; footwear must be safe and appropriate for indoor and outdoor activities. Inappropriate footwear includes, but is not limited to, house shoes/bedroom slippers, and skate shoes.
8. Clothing and accessories including, but not limited to, book bags, backpacks, belt buckles, patches, jewelry, and notebooks must not contain or have printed on them racial/ethnic slurs or symbols, gang symbols/affiliations, or vulgar, obscene, subversive, sexually suggestive language, symbols, or images.

Clothing and accessories such as book bags, backpacks, belt buckles, patches, jewelry and notebooks shall not be derogatory to any individual or groups, or disruptive to the school environment.

Clothing or accessories shall not promote products which students may not legally buy such as alcohol, tobacco, illegal drugs, and controlled substances or promote violence.

9. Items which are prohibited include, but may not be limited to:

- a. Head apparel (hats/caps, scarves, hair picks, stocking caps, hair curlers, the hoods on hoodies or jackets, etc.) inside the school building, except for religious or medical purposes (for which doctor’s verification of need is required);
- b. Sunglasses inside the school building, except for health purposes – doctor’s verification of need is required;
- c. Visible body piercing jewelry (including tongue piercing) other than earrings (if worn, earrings must not pose a threat to the student’s safety nor be disruptive to the peace and good order of the schools);
- d. Large, long, and/or heavy chains (including billfold chains); and
- e. Trench coats, except as needed in very extreme weather.
- f. Tattoos and other similar markings of the skin are discouraged (offensive tattoos must be covered).

The director of schools may allow exceptions for some of the above listed items for special school activities.

Appropriate corrective/disciplinary action will be taken by the school administration if a student comes to school in clothing that is not deemed to be appropriate. Corrective/disciplinary action may include, but is not limited to, calling parents to bring appropriate clothing, detention, in-school suspension and/or other disciplinary action as deemed appropriate. Three dress code violations will result in suspension to the alternative school for no less than twenty (20) days.

The principal’s discretion shall prevail in regard to appropriate attire for all after-school activities.

The Board expects the Director of Schools to require all principals and all certificated personnel to enforce the above dress code in a consistent manner.

Emergency Information

In cases of early dismissal, illnesses, or other emergencies, each student is required to have on file in the office the following information:

- 1. A complete up-to-date physical address (besides P.O. box)
- 2. Home phone number and/or cell phone number
- 3. A parent’s work phone number or cell phone number
- 4. An emergency phone number of a relative or friend
- 5. Medical alert information
- 6. Name(s) of authorized person(s) who may pick up your child
- 7. Change in guardianship

Enrolling or Transferring a New Student

Enrollment Requirements	Transfer Requirements
<ul style="list-style-type: none"> 1. Certified Birth Certificate 2. Social Security Card 3. Immunization Records 4. Physician’s physical report 5. Proof of Residence (TN Dr. Lic. or ID) 	<ul style="list-style-type: none"> 1. Complete transfer form with teacher and principal signature 2. Parent/guardian will pay any fees pending and return all books

6. Proof of Custody	3. Student records will be forwarded when all requirements are met 4. Proof of Residence (TN Dr. Lic. Or ID) 5. Proof of Custody Transfer
---------------------	---

Transfer students will meet the same enrollment requirements as new students. A parent may request through the Director of Schools to attend a school within the system other than the one to which he/she is zoned as determined by the school destination of the school bus going by their home if space is available. However, the parent/guardian must provide their own transportation to and from the school.

Family Involvement

The faculty and staff of North Middle School encourages the involvement of parents, both as individuals and as groups, in the education of children. This involvement includes meaningful participation in the decision-making process in planning, implementing and evaluating. A Parent/Student/Teacher/Principal Compact will be reviewed and signed annually. Students’ progress will be communicated to parents every 4.5 weeks with informal progress reports and every nine weeks with formal report cards. Formal Parent/teacher conferences will be held twice during the school year.

Field Trips and Excursions

Since field trips are a privilege given to students, they must earn the right to participate in this enriched learning environment. Based on attendance, academia and behavioral reports, the principal will determine participation in field trips. Students must have written permission from a parent/guardian to participate in any field trip.

Fire, Tornado, and Safety Drills

Fire, Tornado, and Safety Drill instructions are posted in each classroom. Students are instructed in the procedures to follow in case of fire, tornado, or safety drills. Drills are held periodically so that students and staff may practice procedures.

Grading (Board Policy 4.600)

The director of schools shall develop an administrative procedure to establish a system of grading and assessment for evaluating and recording student progress and to measure student performance in conjunction with board-adopted content standards for grades K-8. The grading/assessment system shall follow all applicable statutes and rules and regulations of the State Board of Education. The grading/assessment system shall be uniform district-wide at comparable grade levels, except that the director of schools shall have the authority to establish and operate ungraded and/or unstructured classes in grades K-3 according to state rules and regulations. The director of schools shall submit a copy of the grading, reporting and assessment systems to the board before the system is implemented. These guidelines shall be communicated annually to students and parents/guardians. Conduct grades are based on behavior and shall not be deducted from scholastic grades.

Subject-area grades shall be expressed by the following letters with their corresponding percentage range:

•A (93-100) •B (85-92) •C (75-84) •D (70-74) •F (0-69)

Progress Reports

In order to keep parents informed of student progress, reports will be sent home at 4.5 weeks of the nine week grading period. For the 21-22 school year, progress reports will come home on September 8th, November 16th, February 8th, and April 26th.

Report Cards

Report cards are issued four times per year after each nine week grading period. Through this report, the school is able to communicate to parents the performance of students. Should you have questions or concerns regarding your child's performance, please contact your child's teacher for a conference. Furthermore, your child's report card, field trips, and special events may be withheld until all fees owed to the school are paid in full. Report cards at North Middle School will have a floor grade of 60 for each quarter. Teachers will not give report card/progress report grades lower than 60. A single low failing score on a 100-point grading scale can have a disproportionate impact on a student's grade and lead to disengagement from his studies. The "why bother" attitude can be devastating. In contrast, a grade floored at 60 for a quarter, leaves the door open to repair a bad decision or missed opportunity; a chance to get back on track. Some students need more time, instruction, encouragement and/or accountability. When low scores indicate academic struggle, we provide timely and targeted support for students, and then reassess before assigning a final grade.

Honor Roll

Honor roll is determined using report card grades for each quarter.

1st Honor Roll: All A's in all subjects (including Related Arts classes)

2nd Honor Roll: Three academic A's and nothing less than a B in Related Arts classes.

Progress Report Distribution Dates	Report Cards Distribution Dates
September 8th, 2021	October 22nd, 2021
November 16th, 2021	January 7th, 2022
February 8th, 2022	March 25th, 2022
April 26th, 2022	May 26th, 2022

Head Lice (Board Policy 6.4031)

The school nurse will notify parents/guardians immediately when their child has been identified as having head lice (including nits). A letter will be sent home by the child to explain the condition, requirements for readmission and deadlines for satisfactory completion of the treatment. Prior to readmission, satisfactory evidence must be submitted to school personnel that the student has been treated for pediculosis (head lice). This evidence may include, but not be limited to: 1. proof of treatment with a pediculicide product (head lice shampoo) 2. satisfactory examination by a school health official

Any subsequent incidents of head lice for that student during the school year will require submission of satisfactory evidence of treatment for head lice and be found free of nits by a school official.

A student will be expected to have met all requirements for treatment and return to school no later than two (2) days following exclusion for head lice. All days in excess of the allowable period will be marked as unexcused and referred to the attendance supervisor at the proper time.

Health Requirements

Immunization: “No Shots, No School”. All students entering for the first time are required to have proof of immunization against diphtheria, pertussis, tetanus, polio, mumps, measles, and rubella. All incoming 7th graders must have a Tdap immunization and a verified form from their physician that specifies they are up to date for 7th grade.

Inclement Weather

If snow, ice, or tornadic conditions occur, turn to a local radio station for information on school closings or early dismissals. The School Messenger system will also notify parents/guardians of any early school dismissals/closings. Procedures for early dismissal will be the same as a normal school day.

Interrogations and Searches (Board Policy 6.303)

School personnel have a duty to report any reasonable suspicion that a student is carrying, or has carried, a weapon or is violating, or has violated, a provision of the Tennessee Drug Control Act to the principal, the principal’s designee or, if the principal and the principal’s designee are unavailable and the offense was committed on school property, to the appropriate authorities. Students may be questioned by teachers or principals about any matter pertaining to the operation of a school and/or the enforcement of its rules. Questioning must be conducted discreetly and under circumstances which will avoid unnecessary embarrassment to the student being questioned. Any student answering falsely, evasively or refusing to answer a proper question may be subject to disciplinary action, including suspension. If a student is suspected or accused of misconduct or infraction of the student code of conduct, the principal may interrogate the student, without the presence of parent(s)/guardian(s) or legal custodians and without giving the student constitutional warnings.

The entire policy can be accessed here [6.303](#)

Lockers

Lockers are assigned to all students in grades 6 – 12. All lockers are school property and are subject to inspection/search at any time. Locks may be purchased through the front office for \$6.00; school purchased locks will be the only locks permitted to be used.

Lost and Found

Please label your child’s belongings to make it possible to return items that are lost. All lost and found items are held for a period of one week after which time items are donated to charity. If your child loses an item, please have him/her check the front office and classroom areas.

Make-Up Work

Make-up work is the sole responsibility of the student. All missed class work, tests, projects, etc. (whether from excused or unexcused absence) is/are required to be made up. All make-up work will be turned in to teachers within three (3) days of absence. ABSOLUTELY NO MAKE-UP WORK WILL BE

ACCEPTED AFTER 3 DAYS. Any work not completed and turned in will result in a zero grade. For multiple consecutive absences, the teacher and student will meet together to determine a fair due date of missed assignments.

Medicine (Board Policy 6.405)

If under exceptional circumstances a child is required to take non-prescription or prescription medication during school hours and the parent cannot be at school to administer the medication, only the school nurse or designee will assist in self-administration of the medication if the student is competent to self-administer medicine with assistance in compliance with the following regulations: Written instructions signed by the parent/guardian will be required and will include: 1. Child's name 2. Name of medication 3. Name of physician 4. Time to be self-administered 5. Dosage and directions for self-administration (non-prescription medicines must have label directions) 6. Possible side effects, if known 7. Termination date for self-administration of the medication The medication must be delivered to the school nurse in person by the parent/guardian of the student. The parent/guardian is responsible for informing the designated official of any change in the student's health or change in medication.

Mission Statement

North Middle School is and will continue to be a caring, progressive, educational environment where students have the opportunity to develop to their highest potential and become prepared for the next level of education through mastery of academic, social, cultural, and physical endeavors.

Nurse

This year North Middle School is fortunate to have the facilities for a school nurse. If a student becomes ill during the school day, the school nurse will contact parents/guardians. Parents are urged to pick up their child as soon as possible to prevent the spread of illness to other students. Students with temperatures of 100 degrees and/or a contagious condition are required to leave school. Please keep contacts up to date so that parents or other designated persons can be contacted in the event of illness or injury at school. All medications will be dispensed by the school nurse/designee from the school clinic. If you have any questions regarding medication being distributed to your child during school hours, please contact the school nurse.

Parent Concerns

In order for North Middle School and our community to continue to grow and achieve full success, it is vital that all communications are conducted respectfully, appropriately, and directly with the faculty, staff, and/or administration. Because positive communication is essential, please adhere to the following procedures with any questions, concerns, or ideas regarding your child, your child's teacher, or North Middle School:

1. Contact your child's teacher via email or phone call.
2. After you have made an initial contact and would like to discuss your concerns further, contact an administrator to schedule a conference with the teacher and an administrator or school counselor.
3. Should you want to further discuss your concerns, please contact the school principal's office for a conference with the teacher, assistant principal, and school's principal.

Please note that posting your questions, concerns, or ideas regarding your child, your child's teacher, or North Middle School via social media may bring undue **negative and undesirable** reflections to our students, faculty/staff, and community, as well as you the parent. Personal posts of individuals to social

media that are slurs, inflammatory, or harassing, etc. of this school, its administration, its faculty or staff, will be reported to the proper authorities and/or prosecuted.

Should you have a question, concern, suggestion, or idea regarding North Middle School, please contact Holly Eslick during regular school hours (8:00 am - 3:00pm).

Parking

When visiting North Middle Schools' campus, please park in the visitor parking area which is located in the front of our school campus. To ensure the safety of our campus is not breached please do not park in fire lanes. These areas are reserved for emergency vehicles.

Perfect Attendance

Students who do not have any absences and no unexcused check-ins or checkouts will be recognized at the end of the year academic awards programs as obtaining perfect attendance for the school year.

Personal Property

North Middle School is not responsible for loss or damage to personal property. All personal belongings should be clearly labeled with the student's name and be kept up with the student.

Saturday School

Students may be assigned to Saturday School as a means of disciplinary action for missed work/work that is to be redone or for behavioral issues. Saturday School will be held the 1st Saturday of the month. Contact for Saturday School notification will be made the previous week prior to the date of assigned Saturday School.

School Counseling

Every student at North Middle School shall have access to a school counselor. School counselors work with students, families, communities, faculties and staff to address issues that have a substantial impact on student academic, personal/social and career development. The program of counseling services shall include such services and activities as:

1. Orientation of parents and students to the school program;
2. Preventative and developmental counseling to students in order to prepare them for their school responsibilities and their social and physical development;
3. Student referral and/or welfare provisions;
4. Collection and maintenance of student data and record systems;
5. Student program planning and placement;
6. Educational and occupational information for use by students, parents and teachers; and
7. Scheduling student courses and resolving conflicts.

School Messenger

In order to better communicate important school information, such as lunch charges, incomplete assignments, student absences, school closings, or events and activities occurring at school, North Middle School has implemented a phone message system which will contact each parent. Therefore, please make every effort to ensure that contact numbers are current and correct at all times. This may be done by verifying with the guidance office secretary.

School Property

Everyone is asked to cooperate in helping to keep both the building and grounds free from damage and litter. Should students mark or damage property or equipment, in any way, parents will be responsible for paying for all damage. School property is defined as buildings, buses, books, equipment, records, instructional materials, or any other item under the jurisdiction of the Franklin County Board of Education.

School Support Organizations

Only a group or organization that has entered into a written cooperative agreement with the Franklin County Board of Education and North Middle School may use the name, mascot or logo of a school or the school district to solicit or raise money, materials, property, securities, services, or other things of value. All school support organizations shall obtain the approval of the principal before undertaking any fundraising activity.

Student Fines

Students who destroy, damage, or lose school property, including but not limited to buildings, school buses, books, equipment, and records, will be responsible for the actual cost of replacing or repairing such materials or equipment. The grade, grade cards, diploma or transcript of a student who is responsible for vandalism or theft or who otherwise has incurred a debt to a school may be held until the student or the student's parent/guardian has paid for the damages. Textbooks are available free to students as a loan. Parent(s) will accept full responsibility for the proper care, preservation, return, or replacement of textbooks issued to the student(s). The condition of each book and a book number shall be recorded by the teacher issuing it.

Student Information System (Skyward)

Students and parents can access grades, attendance, and discipline information through Skyward. For login information, contact **Dena Gillespie** at dena.gillespie@fcstn.net.

Student Suicide Prevention

Our school and school district is committed to protecting the health and well-being of all students and understands that physical, behavioral, and emotional health are integral components of student achievement. Students are strongly encouraged to report if they, or a friend, are feeling suicidal or in need of help. Students will be provided information regarding The National Suicide Prevention Lifeline – 1-800-273-8255 4 (TALK), The Crisis Text Line which is Text “TN” to 741 741, and Youth Villages Mobile Crisis Line 1-866-791-9225.

Telephone

Telephones throughout the school are for business use only and are not for student use except with permission from the attendance office in case of an emergency. If a student becomes sick at school and needs to check out, he/she must see the school nurse in the school clinic who will contact the parent/guardian.

Title I Funding

Schools that meet the criteria are deemed Title I schools. Those schools receive federal funds that

provide additional resources, materials, or personnel to schools that meet certain free and reduced lunch percentages. Funds will be used throughout the school. The school's leadership team, which includes parents, will determine how to spend the funds in accordance with our School Improvement Plan. The following are also needed to be in accordance with title I requirements: Parent Involvement Policy and School Compact (see appendix).

Tobacco Products (Board Policy 1.803)

The use or possession of tobacco or tobacco products by a student is prohibited on school premises and school buses. Any student who has not attained eighteen (18) years of age and who possesses tobacco products shall be issued a citation by the school principal. The citation shall require the student to appear in Juvenile Court. Students over eighteen (18) years of age shall be disciplined appropriately. This includes electronic cigarettes/personal vaporizers, etc.

Visitors

A "visitor" is defined as anyone other than the enrolled students in the school and school employees or officials. When visitors have the privilege to visit our campus, they are to report directly to the school's office. Visitors will be asked to sign-in at their arrival and sign-out at their departure. All visitors will attach a visitor's badge which will be worn visibly during their visit with us. To ensure safety and that the daily routine of your child's education is not interrupted, unscheduled visits to classrooms will not be permitted. Anyone on school property without a visitor's pass is to be reported to the principal. Persons who come onto school property shall be under the jurisdiction of the school principal/designee. Individuals who come onto school property or who contact employees on school or district business are expected to behave accordingly. The principal/designee has the authority to exclude from school premises any persons disrupting the educational programs in the classroom or in the school, disturbing the teachers or students on the premises, or on the premises for the purpose of committing an illegal act.

Websites/Social Media

Websites and social media networking has become an integral part of everyday life for millions of people around the world. Properly used, social media has become an important aspect of how we interact and communicate with our community. The essence of community is the idea that it exists so that we can support others and they, in turn, can support us. In an attempt to keep ALL parents informed of current school events and information, social media sites are for informational purposes only. Please note that anyone (student, parent, community member, family member) is and will be held personally and civilly responsible for the content published on any personal social media site as it pertains to the faculty, staff, administration, students, families of etc; therefore, should refrain from comments that can be interpreted as slurs, demeaning, inflammatory, bullying, or harassing, etc. Furthermore, the faculty, staff, administration, families of, etc. do not post undue negative or undesirable reflections about you as a parent, your child, or your family to any social media and the same courtesy is expected of each of you, your child/ren, your family, etc.

North Middle School maintains both a school website as well as a Facebook page. The website can be found at www.northmiddle.fcstn.net. Our Facebook page is www.facebook.com/nmsfranklincountyttn.

Each teacher at NMS maintains an updated website to inform students and parents/guardians of syllabus requirements, academic standards, assignments, and any other general information needed to

ensure successful communication between the school and home. Those sites can be accessed at <https://northmiddle.fcstn.net/staffdirectory>.

Zero Tolerance (Board Policy 6.309)

In order to ensure a safe and secure learning environment, the following offenses shall not be tolerated:

Weapons & Dangerous Instruments

Students shall not possess, handle, transmit, use, or attempt to use any dangerous weapon on school buses, on school property, or while on school sponsored outings.

Dangerous weapons for the purposes of this policy shall include, but are not limited to, a firearm or anything manifestly designed, made, or adapted for the purpose of inflicting death or serious bodily injury or anything that in the manner of its use or intended use is capable of causing death or serious bodily injury. Violators of this section shall be subject to suspension and/or expulsion from school.

Firearms

In accordance with state law, any student who brings to school or is in unauthorized possession of a firearm on school property shall be expelled for a period of not less than one (1) calendar year. The Director of Schools shall have the authority to modify this expulsion requirement on a case-by-case basis.

Drugs

In accordance with state law, any student who unlawfully possesses any drug, including any controlled substance, controlled substance analogue, or legend drug on school grounds or at a school-sponsored event, shall be expelled for a period of not less than one (1) calendar year. The Director of Schools shall have the authority to modify this expulsion requirement on a case-by-case basis.

Assault

In accordance with state law, any student who commits aggravated assault or commits assault that results in bodily injury upon any teacher, principal, administrator, any other employee of the school, or school resource officer shall be expelled for a period of not less than one (1) calendar year. The Director of Schools shall have the authority to modify this expulsion requirement on a case-by-case basis.

Electronic Threats

In accordance with state law, any student who transmits by an electronic device any communication containing a credible threat to cause bodily injury or death to another student or school employee and the transmission of such threat creates actual disruptive activity at the school that requires administrative intervention shall be expelled for a period of not less than one (1) calendar year. The Director of Schools shall have the authority to modify this expulsion requirement on a case-by-case basis.

Notification

When it is determined that a student has violated this policy, the principal of the school shall notify the student's parent(s)/guardian(s) and the criminal justice or juvenile delinquency system as required by law.

Appendix:

North Middle School Bullying Behavior Chart

Physical Bullying Harm to someone's body or property		Verbal/Emotional Bullying Harm to someone's self-esteem or feeling of safety		Social Bullying Harm to someone's group acceptance	
Level One					
Verbal	Nonverbal	Verbal	Nonverbal	Verbal	Nonverbal
*Expressing physical superiority *blaming the victim for starting the conflict	*Making threatening gestures * defacing property *pushing/shoving * taking small items from others	*Insulting remarks *calling names *teasing about possessions, clothes, physical appearance	*Giving dirty looks *Holding nose or other insulting gestures	*Gossiping *Starting or spreading rumors *Teasing publicly about clothes, looks, relationships, with boys/girls, etc.	*Ignoring someone and excluding them from a group
1st Offense: Student Conference with teacher 2nd Offense: Parent Contact and Counselor/Office Referral 3rd Offense: Office Referral					
Level Two					
*Threatening physical harm	*Damaging property *Stealing *Starting fights *Scratching, biting, or spitting *Pushing, tripping, or causing a fall *Assaulting	*Insulting family *Repeated teasing with phone calls/texts *Insulting about size, intelligence, athletic ability, race, color, religion, ethnicity, gender, disability, or sexual orientation	*Defacing school work or other personal property, such as clothing, locker, or books	*Ostracizing using notes, IMs, e-mail *Posting slander in public places (such as writing derogatory comments in the bathroom)	*Playing mean tricks to embarrass someone
1st Offense: Student Conference with teacher 2nd Offense: Parent Contact and Office Referral (some situations may result in office referral for 1st offense)					
Level Three					
*Making repeated and/or graphic threats (harassing) *Extortion (such as taking lunch money) *Threatening to keep someone silent: "If you tell, I'll hurt you".	* Destroying property *setting fires *physical cruelty *repeatedly acting in a violent, threatening manner	*Harassing because of bias against race, color, religion, ethnicity, gender, disability, or sexual orientation.	*Destroying personal property, such as clothing, books, jewelry *Writing graffiti with bias against race, color, religion, ethnicity, gender, disability, or sexual orientation.	*Enforcing total group exclusion against someone by threatening others if they don't comply.	*Arranging public humiliation
1st Offense: Parent Contact and Office Referral					
Consequences for extreme harassment may be more severe than those listed above based on either the seriousness of the action or on relevant board policy.					

North Middle School Parent Involvement Policy



The faculty and staff of North Middle School embrace the philosophy that parents and school personnel must work together in order to improve the quality of education for all students. To ensure parents have the opportunity for input into the planning, design, implementation, and evaluation of school programs, including the Title I program, North Middle School will:

- Host an annual meeting with all North Middle stakeholders . This meeting will provide the following:
 - Explanation of the Title I program and services
 - Information concerning Title I laws, regulations, and guidelines
 - Invitation to serve on the school's Advisory Team and to make suggestions for the program
 - Distribution of the school's Parent Involvement Policy to parents
 - Information about the school's goals
- North Middle School will establish a Parent Advisory Team which will work with the school's leadership consisting of the school principal, classroom teachers, and Title I director.
- The Parent Advisory Team at North Middle School will meet on an as-needed basis for the purpose of providing input into the planning, implementing, and evaluating of the Title I program on a school-wide basis.
- A parent/student/teacher/principal compact will be reviewed by the Title I team and signed by all parties and returned to North Middle School at the beginning of the year.
- Students' progress will be communicated to parents every four and half weeks with progress reports and every nine weeks with report cards. Student grades are also available for viewing through the Skyward portal at any time.
- Parent/Teacher conferences will be held two times during the 2021-2022 school year.
- Input from parents will be gathered by a needs assessment survey.

At North Middle School, we encourage the involvement of parents, and we invite you to share your ideas and concerns with us. By working together, we provide our children with the greatest opportunities for success.

Holly Eslick, Principal
holly.eslick@fcstn.net

Ric Roberts, Assistant Principal
ric.roberts@fcstn.net

North Middle School Home and School Compact



North Middle School Student Agreement Signature: _____

It is important that I work to the best of my ability. Therefore, I will strive to do the following:

- Attend school regularly and be on time to classes.
- Go to class with all supplies necessary to participate in my learning.
- Follow all school and district rules and policies.
- Accept responsibility for completing and turning in all assignments.
- Use my classroom time wisely.

North Middle School Parent/Guardian Agreement Signature: _____

I want my child to achieve. Therefore, I will encourage him or her by doing the following:

- See that my child is punctual and attends school regularly.
- See that my child has the supplies needed for learning.
- Support the school in its efforts to maintain proper discipline.
- Encourage my child's efforts and be available for questions.
- Establish a regular routine for completing homework
- Provide a quiet, well-lighted place for homework.

North Middle School Teacher Agreement Signature: _____

It is important that students achieve. Therefore, I will strive to do the following:

- Provide a challenging, standards-based educational program, preparing students for success in high school and beyond.
- Provide a variety of instructional strategies and activities to address the varied learning strengths of our students.
- Provide a nurturing and positive environment in which all students can feel supported and safe emotionally, intellectually, and physically.
- Provide students opportunities to take on more responsibilities and to make increasingly important choices about their own behavior and academics while encouraging integrity and honesty.

North Middle School Principal Agreement Signature: _____

I support and encourage parental involvement. Therefore, I will strive to do the following:

- Provide an environment that allows for positive communication between students, teachers, parents, and myself.
- Provide a nurturing and positive environment in which all students can feel supported and safe emotionally, intellectually, and physically.
- Provide students opportunities to take on more responsibilities and to make increasingly important choices about their own behavior and academics while encouraging integrity and honesty.

2021-2022 North Middle School Supply List



6th Grade	7th Grade	8th Grade
(2) composition books (3) plastic folders with pockets & brads (one of each color: red, green, and blue) (1) 1 inch 3-ring binder (1) 1 ½ inch 3-ring binder (2) packs of notebook paper (3) Clorox Wipes (9) Glue Sticks (2) pack highlighters (2) packs of colored pencils (2 - 3 pks) black Dry Erase Markers (3) Packs sharpened Wood Pencils (1) Handheld Pencil Sharpener (1) Pencil Pouch with Zipper and holes to be kept in binder (1) Pair of scissors **Basic Earbuds- to be left at school. -No Bluetooth or headphones <u>PERSONAL SIZE GERM-X</u> <u>Boys:</u> (3) boxes of Kleenex (1 pack) Red Pens <u>Girls:</u> Germ-X (Large Bottle) (1 pack) Cap Erasers	Notebook Paper 2 packs #2 pencils (1st period teacher) 1 box of Kleenex (1st period teacher) 2 Clorox wipes (1st period teacher) Hand Sanitizer (1st period teacher) 1 Composition book (Language Arts) 2 glue sticks Colored pencils Highlighters 1-2 pack dry erase markers (1st period teacher) 3 pocket folders with brads 3-1" binder 2- Dividers -8 tab Basic Earbuds- to be left at school Notecards <u>PERSONAL SIZE GERM-X</u>	Inexpensive Corded Earbuds or Headphones (no wireless) Paper Graph paper Pencils 6 Glue sticks (science) Red and blue pen 1 pack highlighters(all classes) 1 large box of colored pencils (all classes) 2 pks 3x5 index cards (History) 2 composition books (Science, English) 1 - 1 inch 3 ring binder (English) 1 - 1 inch 3 ring binder (Science) 1 - 2 inch 3 ring binder (Math) 1 pack dividers and tabs 2 - pocket folder with brads (History) Kleenex (1" period teacher) Clorox wipes (1" period teacher) Expo markers (1" period teacher) Hand Sanitizer (1st period teacher) <u>PERSONAL SIZE GERM-X</u> OPTIONAL - own copy of <i>The Outsiders</i> (ISBN 978-0-14-038572-4 or ISBN 0-14-240733-X)

Related Arts (These rotate every quarter so students will not need these items until indicated on their schedule in Skyward).

Optional Supplies for Art: sketchbook, black sharpie, colored pencils or markers, watercolor set, Clorox wipes, and paper towels.
Exploratory: pocket folder with brads
Optional STEM: kleenex, clorox wipes, kleenex, glue sticks, colored pencils
Optional Supplies for Media Arts: clorox wipes, kleenex

FRANKLIN COUNTY SCHOOLS 2021-2022 SCHOOL CALENDAR

July				
M	T	W	TH	F
			1	2
5	6	7	8	9
12	13	14	15	16
19	20	21	22	23
26	27	28	29	30

August				
M	T	W	TH	F
2	3	4	5	6
9	10	11	12	13
16	17	18	19	20
23	24	25	26	27
30	31			

September				
M	T	W	TH	F
		1	2	3
6	7	8	9	10
13	14	15	16	17
20	21	22	23	24
27	28	29	30	

Aug 5 - election day

October				
M	T	W	TH	F
				1
4	5	6	7	8
11	12	13	14	15
18	19	20	21	22
25	26	27	28	29

November				
M	T	W	TH	F
1	2	3	4	5
8	9	10	11	12
15	16	17	18	19
22	23	24	25	26
29	30			

December				
M	T	W	TH	F
		1	2	3
6	7	8	9	10
13	14	15	16	17
20	21	22	23	24
27	28	29	30	31

Oct 8-Fair Day

January				
M	T	W	TH	F
3	4	5	6	7
10	11	12	13	14
17	18	19	20	21
24	25	26	27	28
31				

February				
M	T	W	TH	F
	1	2	3	4
7	8	9	10	11
14	15	16	17	18
21	22	23	24	25
28				

March				
M	T	W	TH	F
	1	2	3	4
7	8	9	10	11
14	15	16	17	18
21	22	23	24	25
28	29	30	31	

April				
M	T	W	TH	F
				1
4	5	6	7	8
11	12	13	14	15
18	19	20	21	22
25	26	27	28	29

May				
M	T	W	TH	F
2	3	4	5	6
9	10	11	12	13
16	17	18	19	20
23	24	25	26	27
30	31			

June				
M	T	W	TH	F
		1	2	3
6	7	8	9	10
13	14	15	16	17
20	21	22	23	24
27	28	29	30	

May 3 - election day

94

180

Required

Staff Development Days:
 August 2, 2021
 August 3, 2021
 August 4, 2021
 August 5, 2021 County-wide
 January 3, 2022

Administrative Days:
 August 6, 2021
 May 27, 2022

Fall

October 18, 2021, 3:15 - 6:15 pm - Middle Schools
 October 19, 2021, 3:15 - 6:15 pm - Elementary & HS
 October 21, 2021, 3:15 - 6:15 pm - FCHS

180 required, student school days--includes the three following abbreviated days:
 August 9, 2021
 December 17, 2021
 May 26, 2022

Three of the available stock-piled days will be devoted to Staff Development
Early Release Wednesdays (students released at 2:30 pm)
 PLCs from 2:45 - 3:30 pm (Attendance required of Certified staff)

No School

Spring

March 7, 2022, 3:15 - 6:15 pm - Middle Schools
 March 8, 2022, 3:15 - 6:15 pm - Elementary
 March 10, 2022, 3:15 - 6:15 pm - FCHS & HS



6th Grade	7th Grade	8th Grade
304- Math	402- Intervention	602- Math
305- Science	404- Intervention	604- Math
306- Math	405- Math	607- ELA
307- Science	406- Science	608- Social Studies
308- ELA	407- Math	609- ELA
309- ELA	408- Science	610- Science
310- Social Studies	409- ELA	611- Social Studies
311- Social Studies	410- ELA	613- Science
	411- Social Studies	
	412- Social Studies	

- Related Arts**
- Library- Mrs. Brown
 - 103 & 104- Band/Chorus
 - 212- CDC
 - 213- Keyboarding/Computer Application
 - 214- CDC
 - 215- Fine Arts
 - 216- Behavior Specialist
 - 218- PT/OT
 - 222- Speech/Language
 - 224- Technology
 - 301- In School Suspension
 - 302- STEM
 - 303- Exploratory
 - 403- Media Arts
 - 601/Gym- Health/Safety
 - 603/Gym- Physical Education

- Office**
- Front Office- Mrs. Amacher
 - 101- SRO Mr. Clark
 - 201- Nurse Lavender
 - 202- Mrs. Eslick (Principal)
 - 204- Mrs. Gillespie (Attendance)
 - 206- Mrs. Prince (Bookkeeper)
 - 208- Mr. Roberts (Assistant Principal)

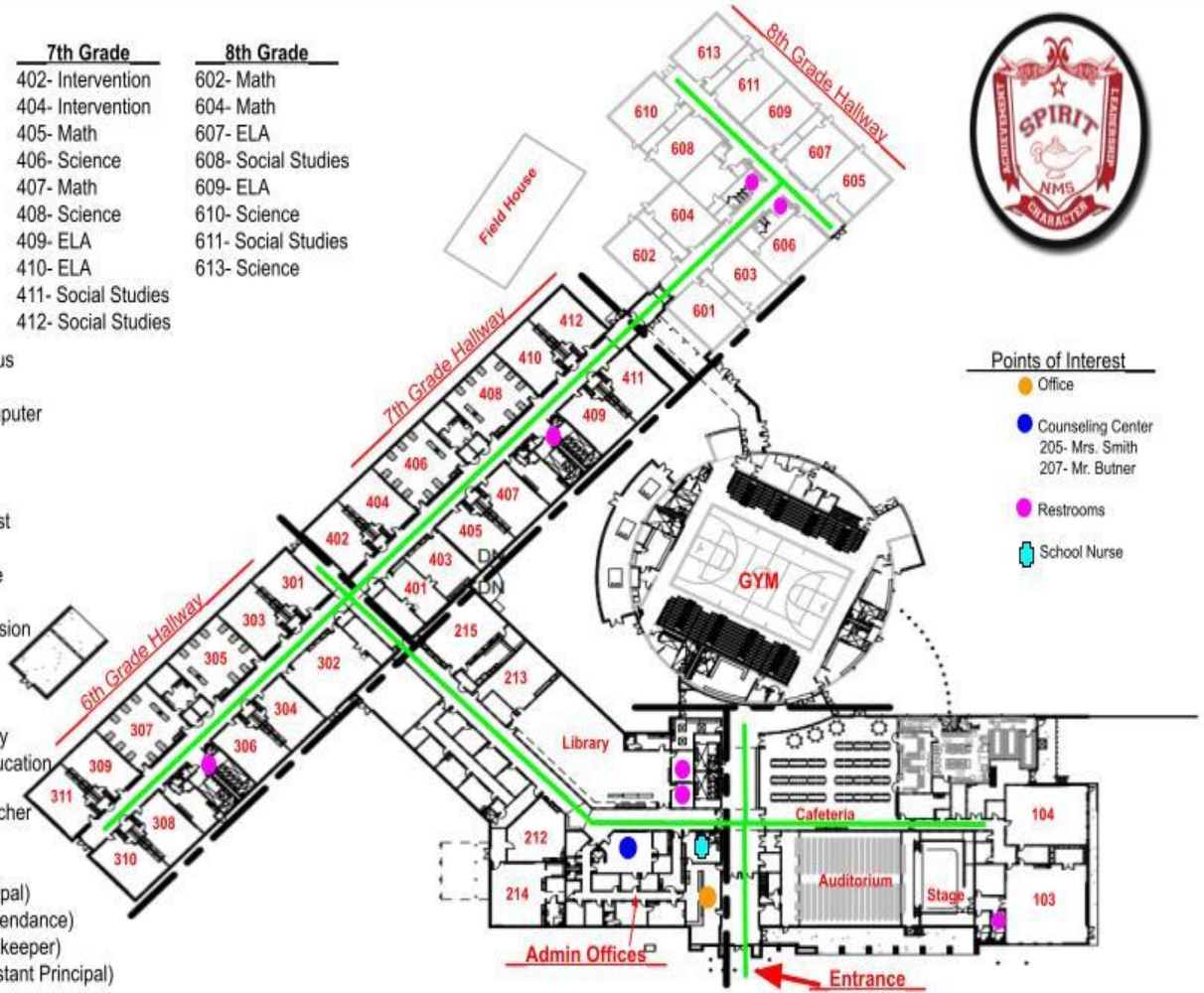

Points of Interest

- Office (Yellow circle)
- Counseling Center (Blue circle)
 - 205- Mrs. Smith
 - 207- Mr. Butner
- Restrooms (Pink circle)
- School Nurse (Light blue square)